

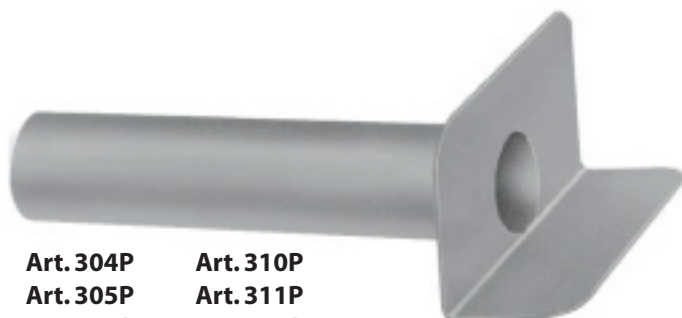

Art. 45.10



Art. 39.2P



**Art. 304P
Art. 305P
Art. 307P
Art. 309P**

**Art. 310P
Art. 311P
Art. 312P**

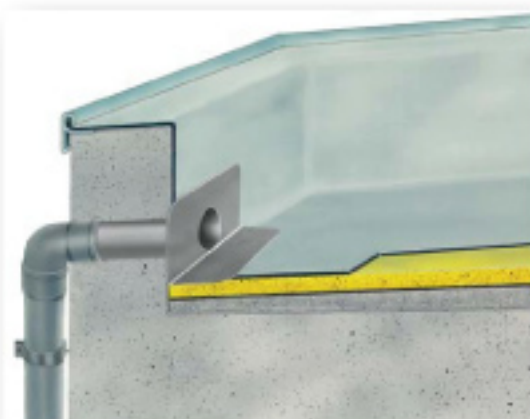
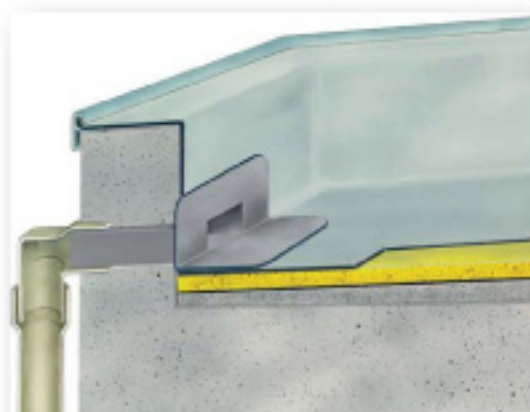

Art. 46 Curve Ø 80



Art. 47 Curve Ø 100



Art. 44.1 Leaf grate

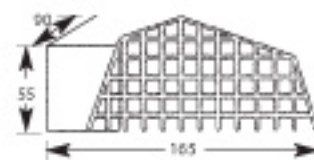

Art. 40
Curve
mm 100x100 Ø 80



Art. 41
Curve
mm 100x100 Ø 100



Art. 26 Leaf-grate



Art. 42
Curve
mm 100x100



Art. 43
Reducer
mm 100x100 Ø 100



Art. 315
Curve
Ø 100



Art. 320
Curve
Ø 110



**Art. 118G
Art. 118M**
Drain box

TPO ANGLED ROOF DRAINS 90° rectangular **Art. 45.1**, square **Art. 39.2A**, with rounded pipe **Art. 304P - 305P - 307P - 309P - 310P - 311P - 312P**, offer as one of the main characteristics the use either as an external or internal drain and especially for horizontal drains through thick outer walls. The ITALPROFILI® angled roof drains are used in conjunction with bends or fittings having seal rings and thus the joint can be within the wall and the down pipe can be placed at a minimum distance from the wall. Installation should be carried out at 3° slope.

ART.	45.10	39.2P	304P	305P	307P	309P	310P	312P
A	120	100	120	120	120	120	120	120
B	140	180	170	170	170	170	170	170
C	-	39.2	500	500	500	500	500	500
H	65	100	63	75	80	90	100	115
L1	97	100	-	-	-	-	-	-
L	450	500	500	500	500	500	500	500

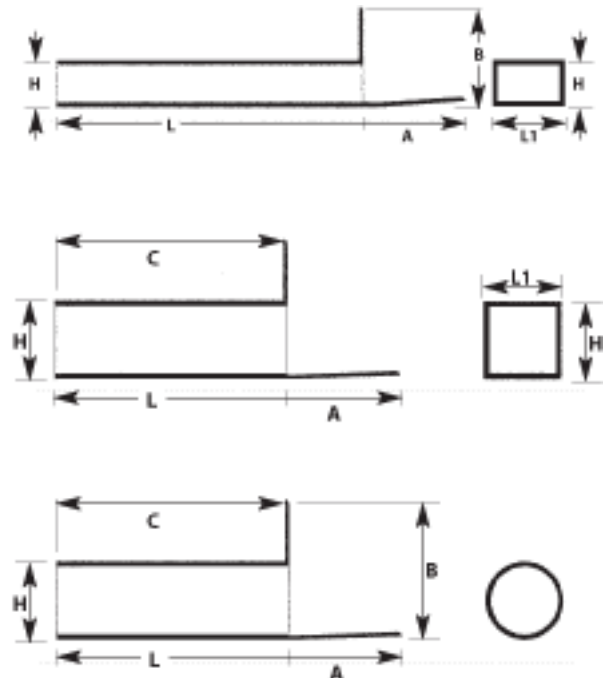

ART.	46	47	40	41	42	43	315	320
A	50	50	50	50	50	50	65	65
D	80	100	Ø 80	Ø 100	100x100	Ø 100	Ø 100	Ø 110
H	68x100	68x100	100x100	100x100	100x100	100x100	Ø 110	Ø 110

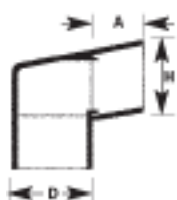

Art. 46

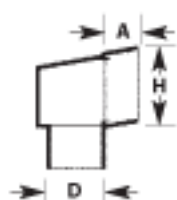

Art. 40

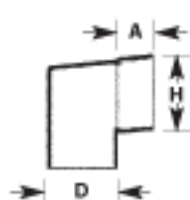

Art. 41

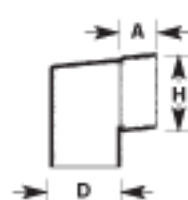

Art. 42

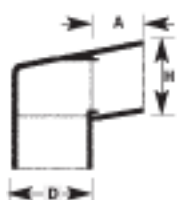
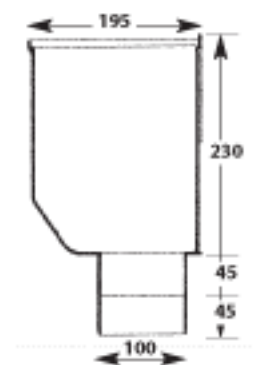

Art. 47

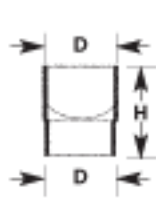

Art. 43

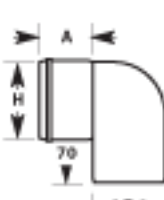

Art. 315

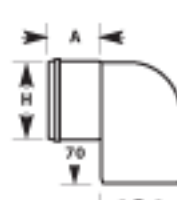

Art. 320

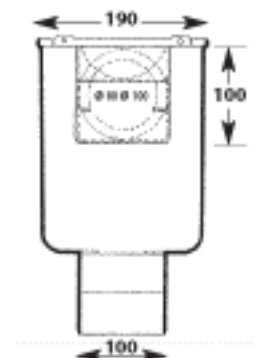

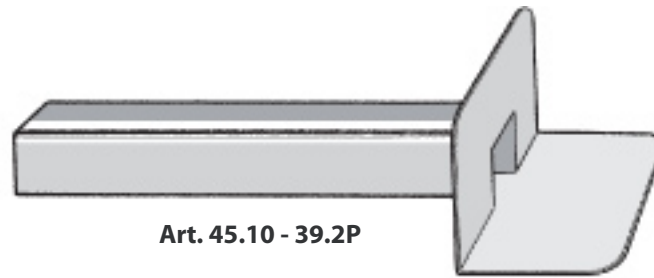

Art. 45.10 - 39.2P

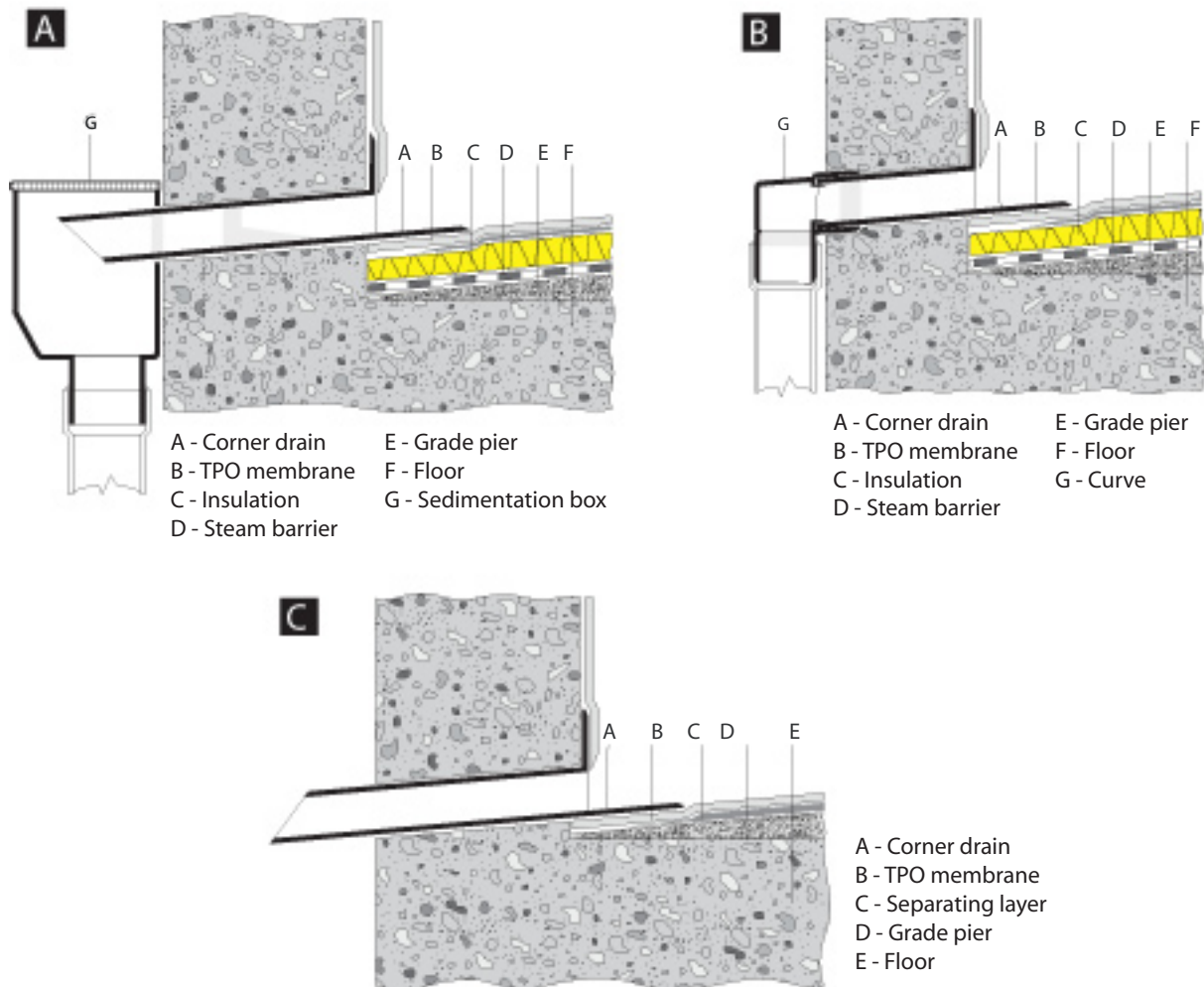

INSTALLATION MANUAL

Art. 45.10 e 39.2P IN TPO

- 1 - Spreading of the TPO membrane; cut the membrane by the hole.
- 2 - Try the drain in the hole and, at the same time, mark the point to cut in relation to the thickness of the wall. The cutting of the pipe shall be made in such a way that the lower part is 5 mm. longer than the higher one, in case this is used with curves art. 46 and 47. In case the drain is placed in the box art. 118, it shall be cut at 45° (see drawing A) and laid with a grade of 3°.
- 3 - Weld the drain flange on the membrane (see drawing B), with hot air or with adhesives suitable for plasticized TPO.
- 4 - Before inserting the curve, pass an adhesive cord suitable for plasticized TPO after having inserted the curves, make sure that the drain pipe is inserted in the four tangs that are inside the curves.
- 5 - Insert the Leaf grate/Gravel grate - art. 44.1 (for art. 45.10) and/or art. 44 (for art. 39.2A).

N.B.: point 1 can be inverted with point 2.

DESCRIPTION OF SPECIFICATIONS - Art. 45.10

Supply and laying of TPO drain of the ITALPROFILI® type, with an angle of 90°, with the following dimensions: shaft 450 mm. long, 65 mm. high, 100 mm. wide the flange shall be smooth and flexible, provided with curves for the connection to downspouts, with a Ø of 80 or 100 or/and a funnel box.

DESCRIPTION OF SPECIFICATIONS - Art. 39.2P

Supply and laying of TPO drain of the ITALPROFILI® type, with an angle of 90°, with the following dimensions: shaft 500 mm. long, 100 mm. high, 100 mm. wide the flange shall be smooth and flexible, provided with curves for the connection to downspouts, with a Ø of 80 or 100 or/and a funnel box to downspouts, complete with Leaf grate/Gravel grate.

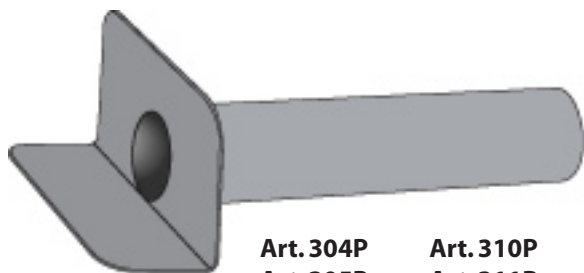

Art. 304P
Art. 305P
Art. 307P
Art. 309P

Art. 310P
Art. 311P
Art. 312P



Art. 320

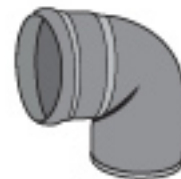

Art. 315

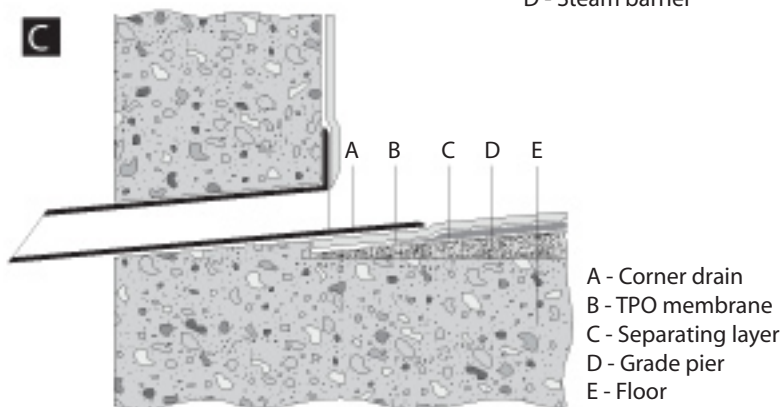
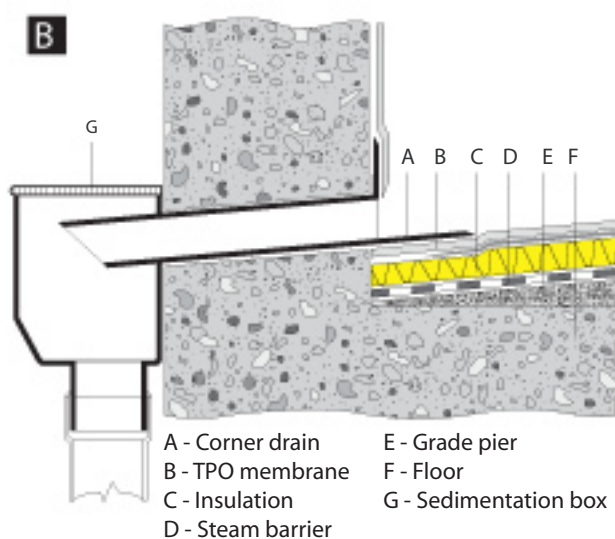
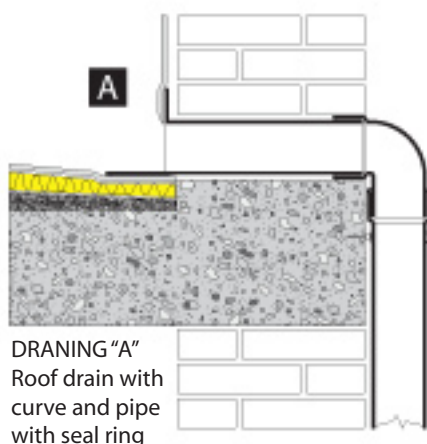

INSTALLATION MANUAL

Art. 304P - 305P - 307P - 309P - 310P - 311P - 312P - 315 - 320

- 1 - Spreading of the TPO membrane; cut the membrane by the hole.
- 2 - Try the drain in the hole and, at the same time, mark the point to cut in relation to the thickness of the wall. The cutting of the pipe shall be made in such a way that the lower part is 5 mm. longer than the higher one, in case this is used with curves with a Ø..... In case the drain is placed in the box art. 118, it shall be cut at 45° (see drawing B) and laid with a grade of 3°.
- 3 - Weld the drain flange on the membrane (see drawing B), with hot air or with adhesives suitable for plasticized TPO.
- 4 - Before inserting the curve, pass an adhesive cord suitable for plasticized TPO, if possible use curves provided with seal piece.
- 5 - Insert the Leaf grate/Gravel grate - art. 26.

N.B.: point 1 can be inverted with point 2.

DESCRIPTION OF SPECIFICATIONS

Supply and laying of stabilized TPO drain of the ITALPROFILI® type, with an angle of 90°, with the following dimensions: shaft 500 mm. long, Ø....., the flange shall be smooth and flexible, provided with curves for the connection to downspouts, with a Øor/and a funnel box to downspouts, complete with Leaf grate/Gravel grate.